

Modellname: **NATURE TWO**
 Nazwa modelu:

Modellreihe: **1211--01**
 Numer modelu:

Type: **01**
 Typ:

Blatt Nr **1** von: **9**
 Strona z:



Tabelle mit Maßen/Menge und Colli-Nr. der Einzelteile

NO	Dim.	Colli-No	Qty
1	823	380	1
2	823	360	1
3	1940	380	2
4	1940	380	2
5	1884,5	360	2
6	354	353	1
7	454	330	1
8	1904	366	2
9	1904	466	2
10	1880	405	2
11	303	116	1
12	1908	70	2
13	1908	70	2
14	856	32	1
15	823	25	1
16	454	320	1
17	353	340	1
18	303	116	1
19	303	116	1
20	494	302	1
21	1119	302	2

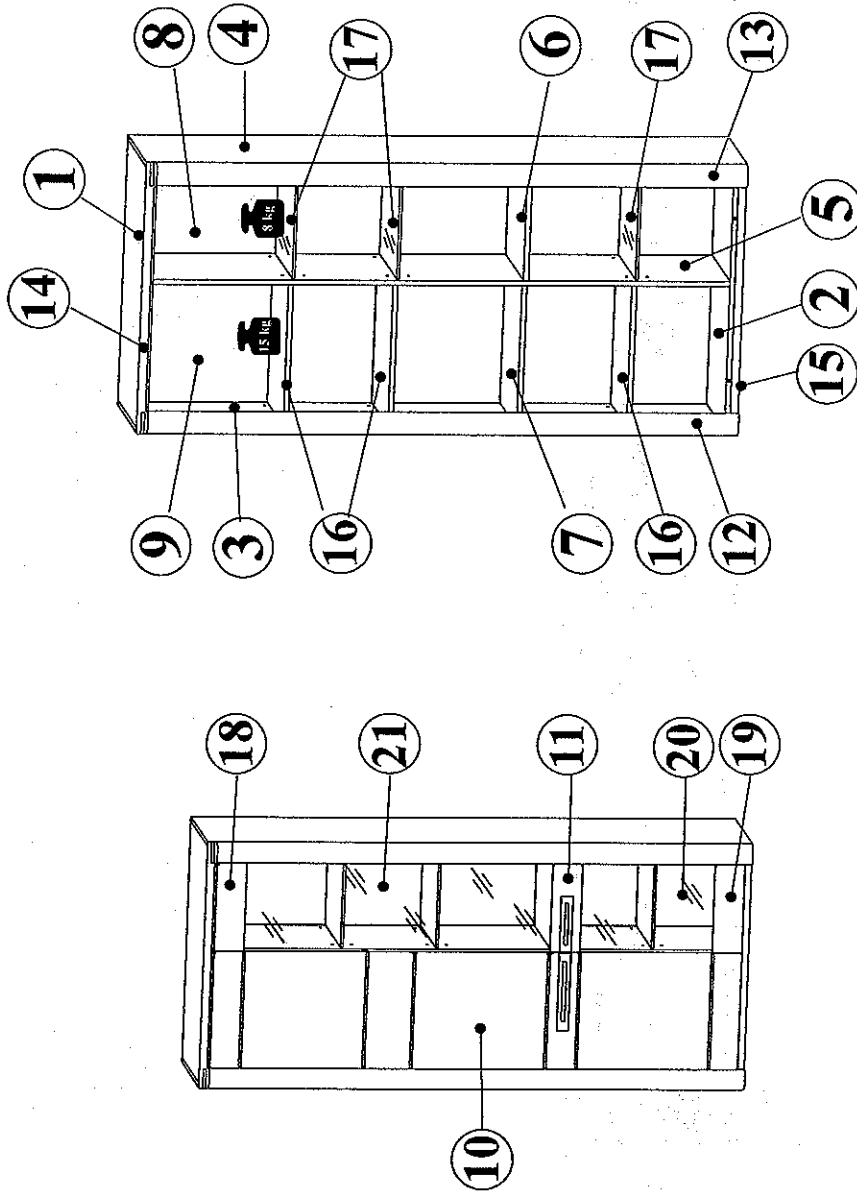
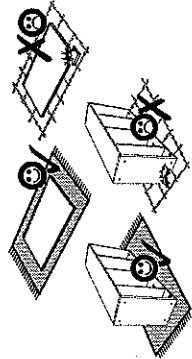
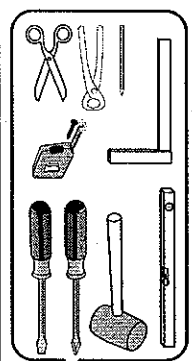
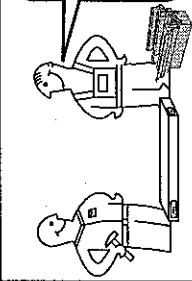
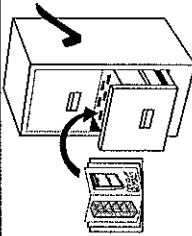

Modellname: **NATURE TWO**
Nazwa modelu:

Modellreihe: **1211--01**
Numer modelu:

Type: **01**
Typ:

Blatt Nr **2** von: **9**
Strona z:

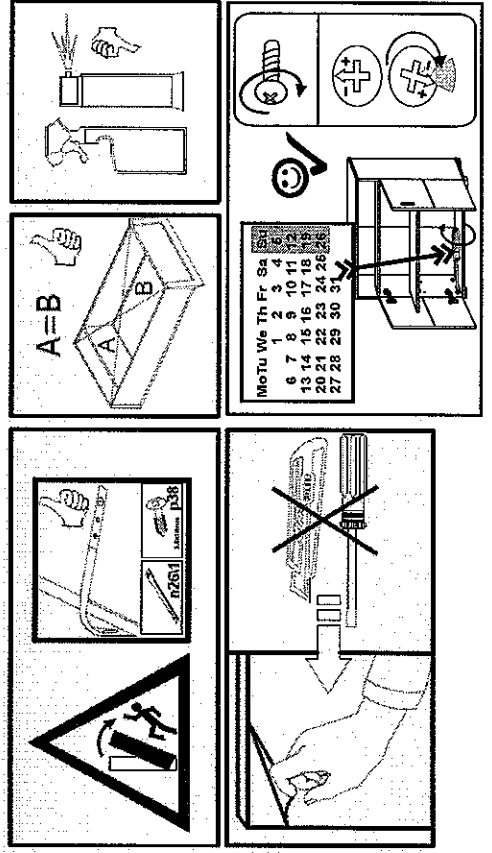
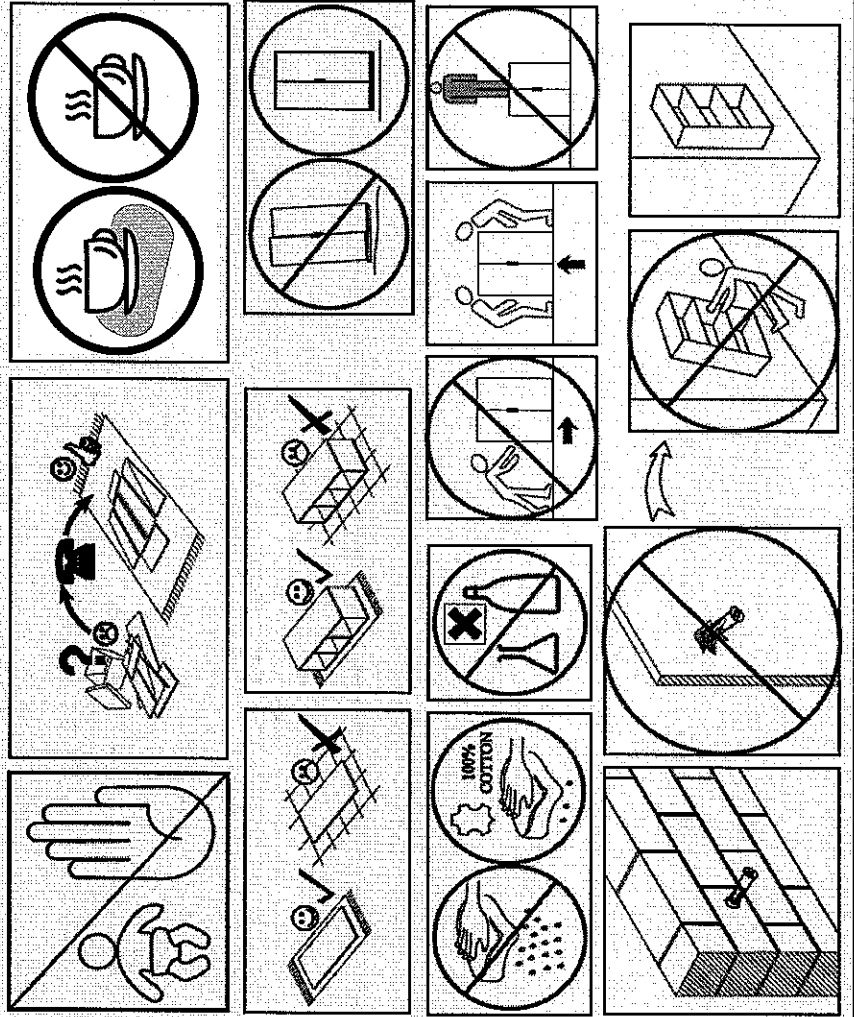
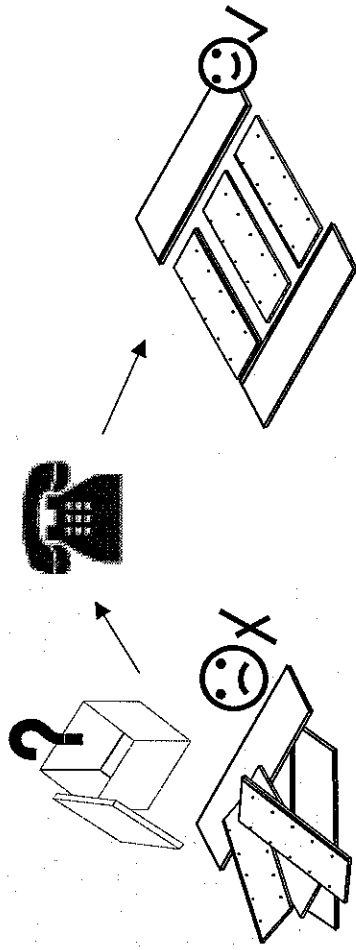

Modellname: **NATURE TWO**
 Nazwa modelu:

Modellreihe:
 Numer modelu:

1211--01

Type: **01**
 Typ:

Blatt Nr **3** von: **9**
 Strona z:

NR 1	(M1) φ15x12mm x35	(T1) 5x39mm x31	(T18) L-64 x2	(B1) φ 8x28 x20	(B20) φ 8x50 x2	(C2) x35	(F15) x8	(W1) x12	(W2) x12
-------------	--------------------------------	------------------------------	----------------------------	------------------------------	------------------------------	--------------------	--------------------	--------------------	--------------------

NR 2	(J23) x18	(F1) x8	(S6) 3,0x20 x18	(P16) 4x16 x12	(G4) x12	(P13) 3,5x13 x24	(F12) x6
-------------	---------------------	-------------------	------------------------------	-----------------------------	--------------------	-------------------------------	--------------------

NR 3	(Y0) x7	(Z5) x2	(D7) x7	(E3) 6,3x13 x14	(S8) 4x13 x14
-------------	-------------------	-------------------	-------------------	------------------------------	----------------------------

NR 4	(SW60) x1	(SW28) x1	(A2) M4x22 x4
-------------	---------------------	---------------------	----------------------------

NR 5	(J11) x1	(P13) 3,5x13 x2	(T13) 8x50 mm x1	(T14) 6x50 mm x1
-------------	--------------------	------------------------------	-------------------------------	-------------------------------

NR 6	(O21) MAX 3,6W x1	(Z3S) x3
-------------	--------------------------------	--------------------

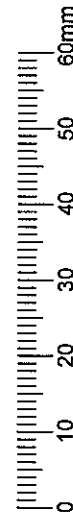

Modelname: **NATURE TWO**
 Nazwa modelu:

Modellreihe: **1211--01**
 Numer modelu:

Type: **01**
 Typ:

Blatt Nr **4** von: **9**
 Strona z:

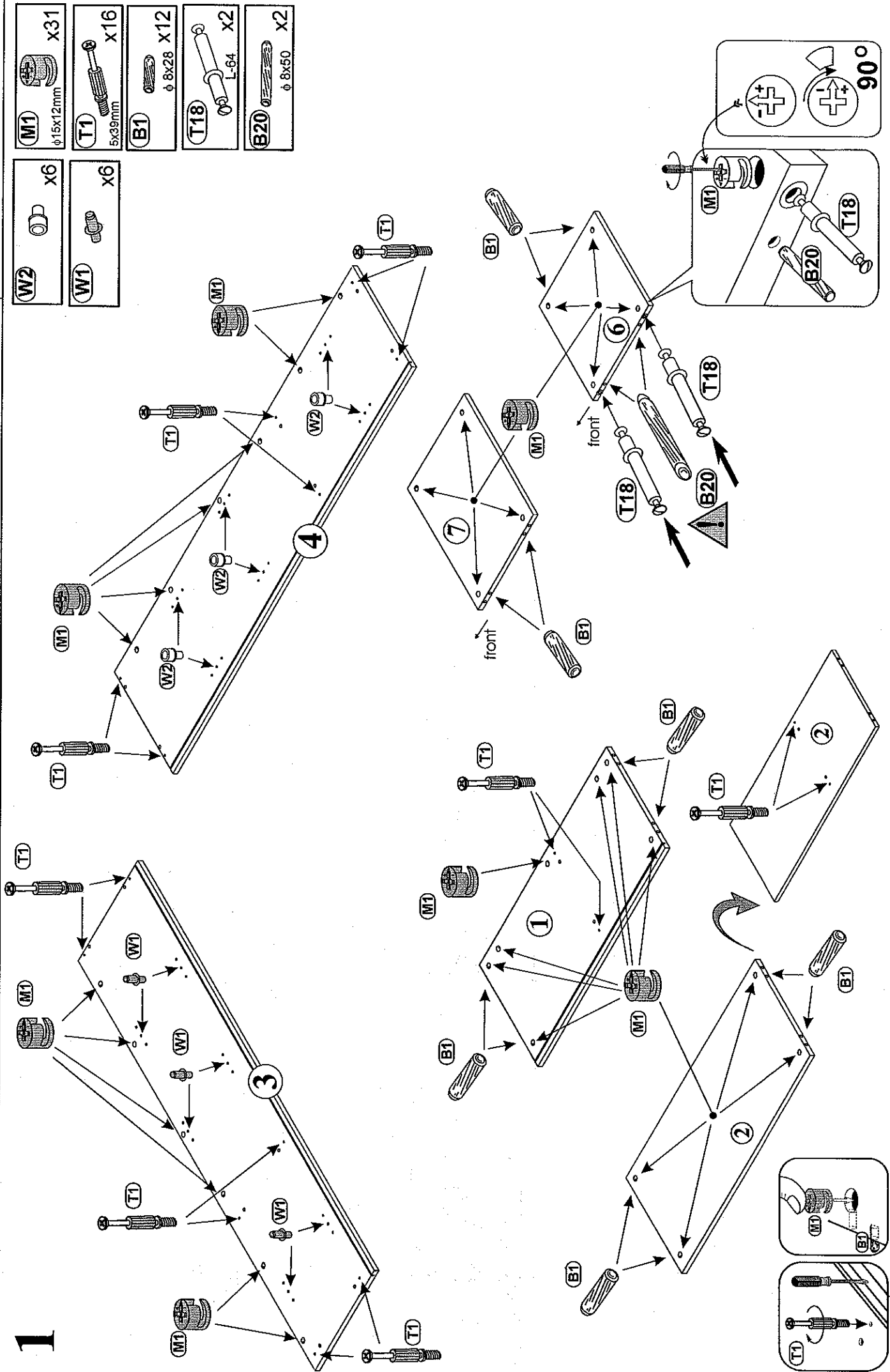

- | | | | |
|------------|--|----------|-----|
| M1 | | φ15x12mm | x31 |
| T1 | | 5x39mm | x16 |
| B1 | | φ 8x28 | x12 |
| T18 | | L-64 | x2 |
| B20 | | φ 8x50 | x2 |

- | | | |
|-----------|--|----|
| W2 | | x6 |
| W1 | | x6 |

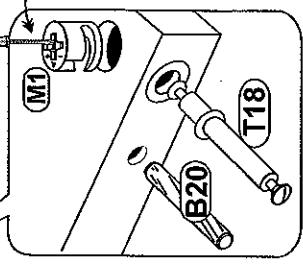
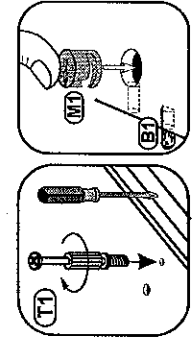

Modellname: **NATURE TWO**
Nazwa modelu:

Modellreihe: **1211--01**
Numer modelu:

Type: **01**
Typ:

Blatt Nr **5** von: **9**
Strona z:

2

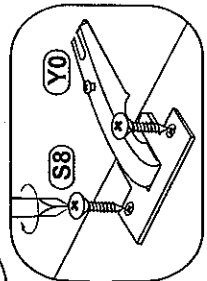
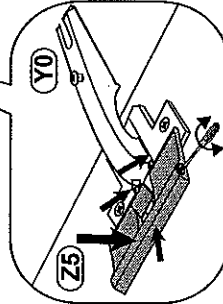
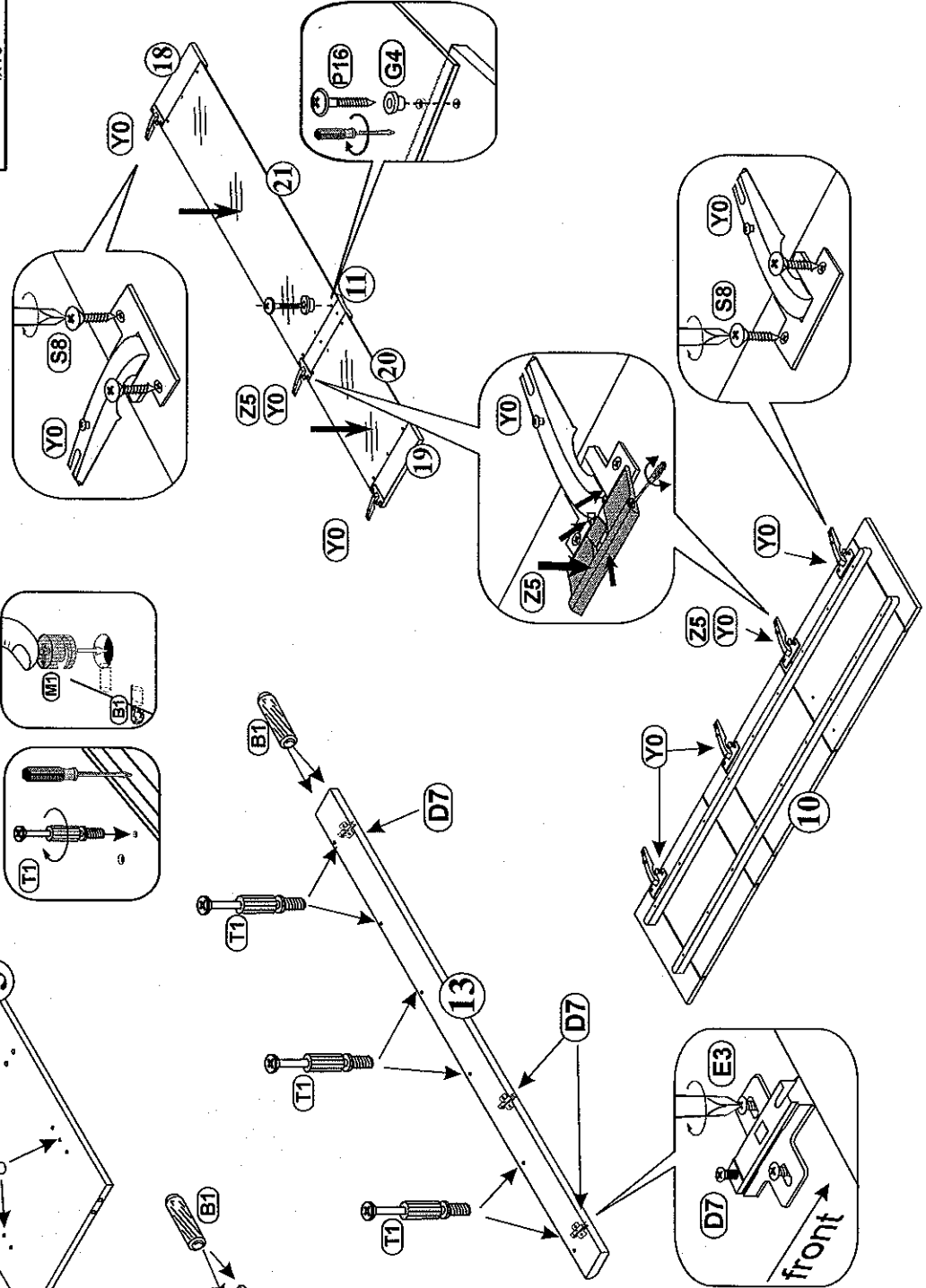
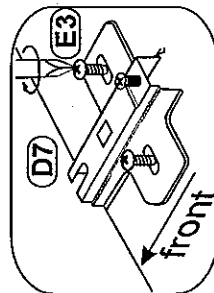
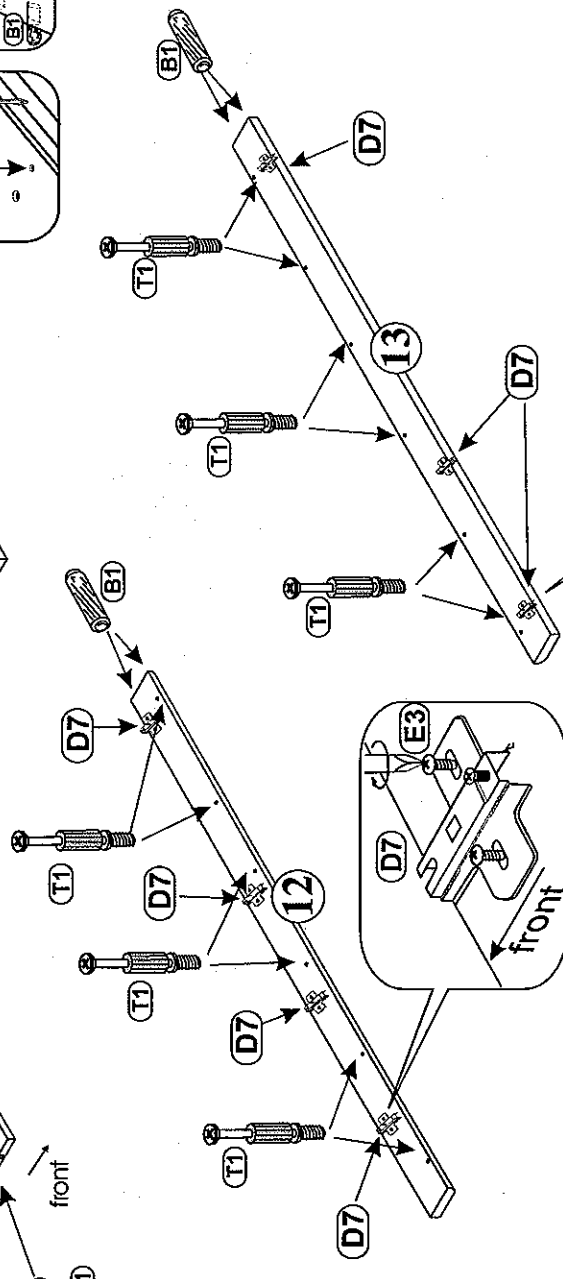
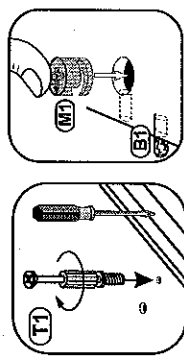
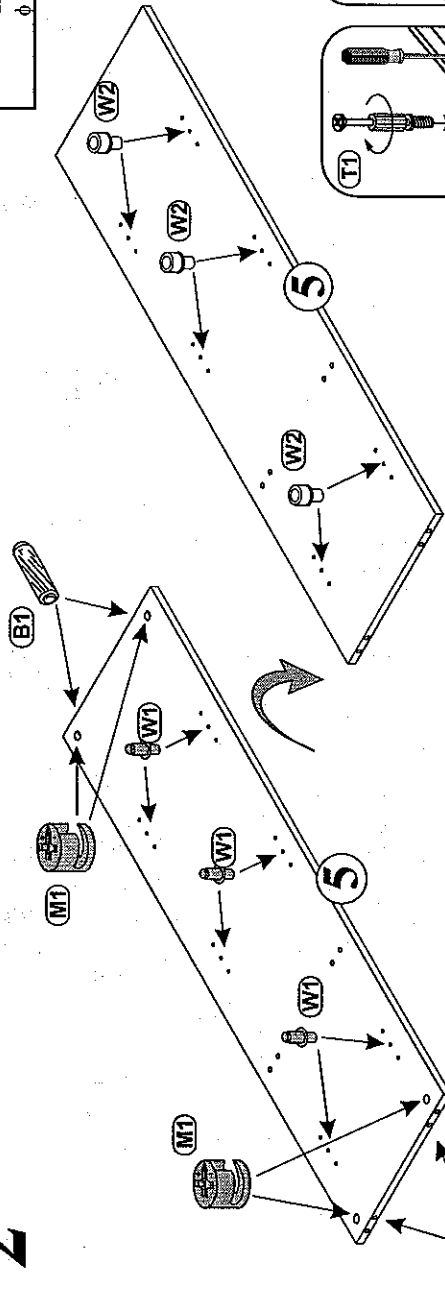
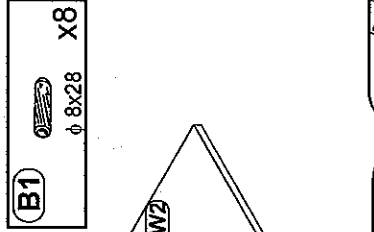
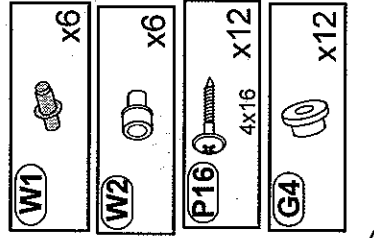
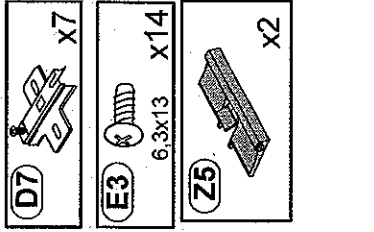
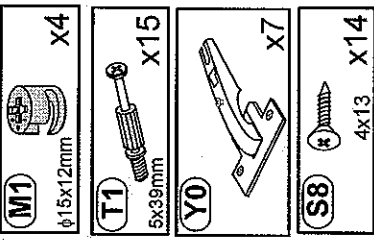

Modelname: **NATURE TWO**
Nazwa modelu:

Modellreihe: **1211--01**
Numer modelu:

Type: **01**
Typ:

Blatt Nr **6** von: **9**
Strona z:

3

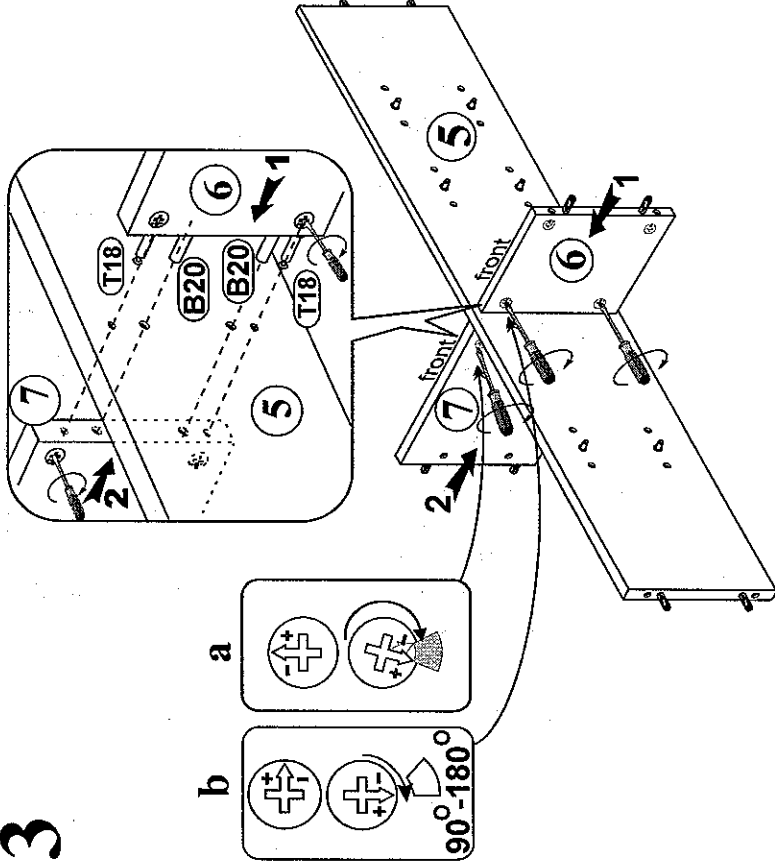

5

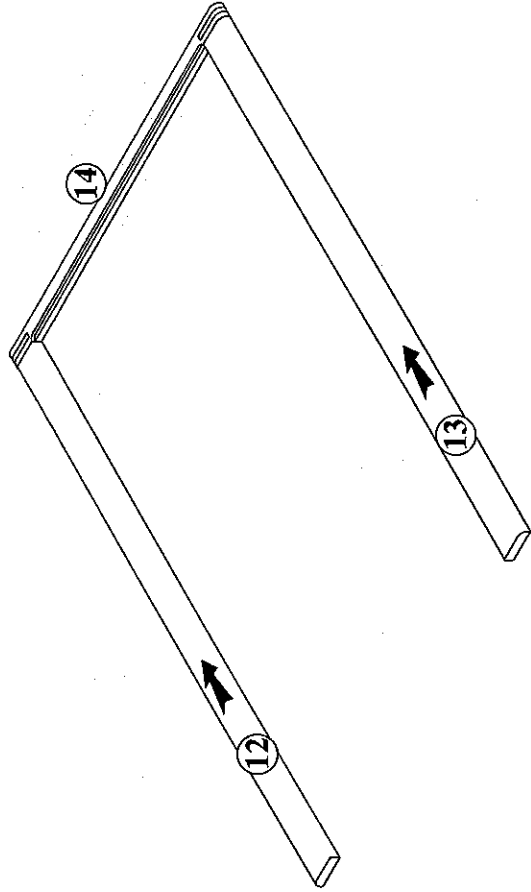

6

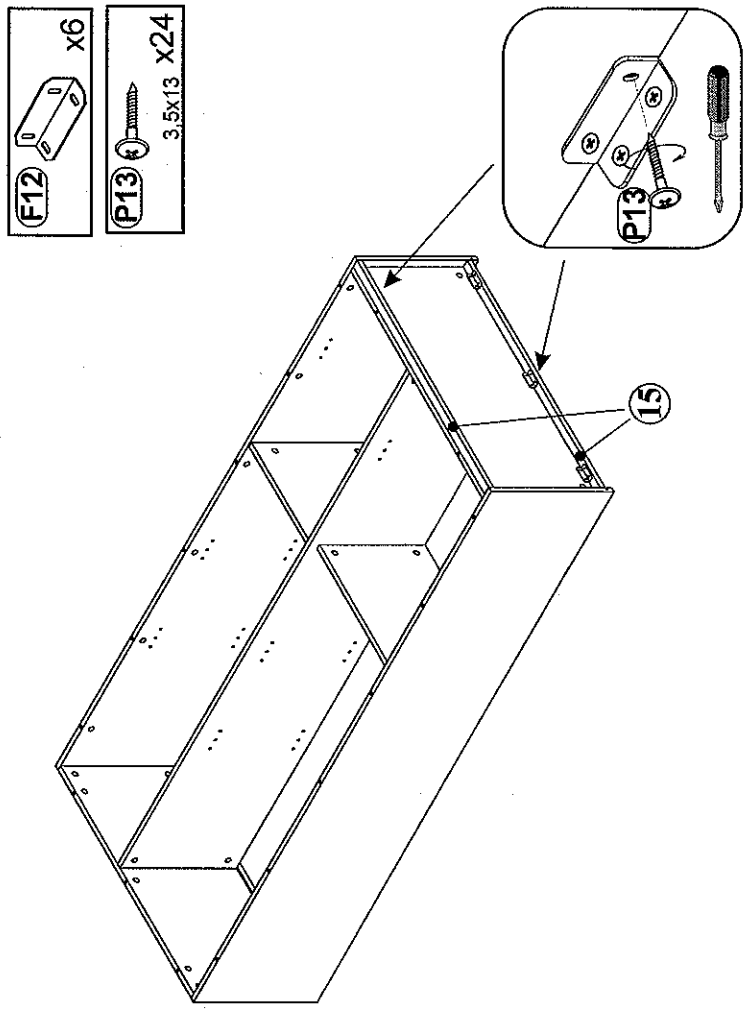

4

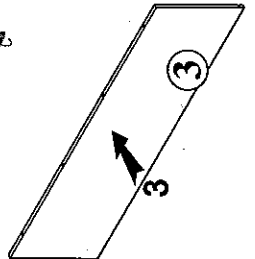
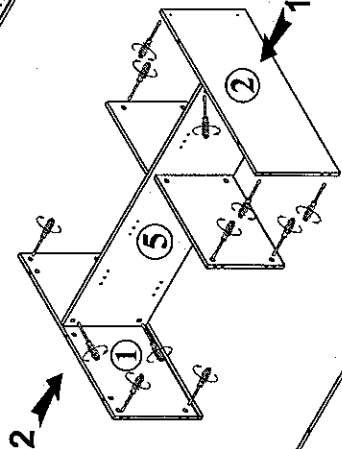
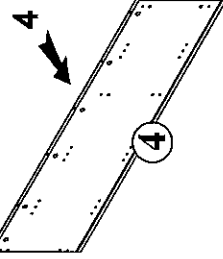
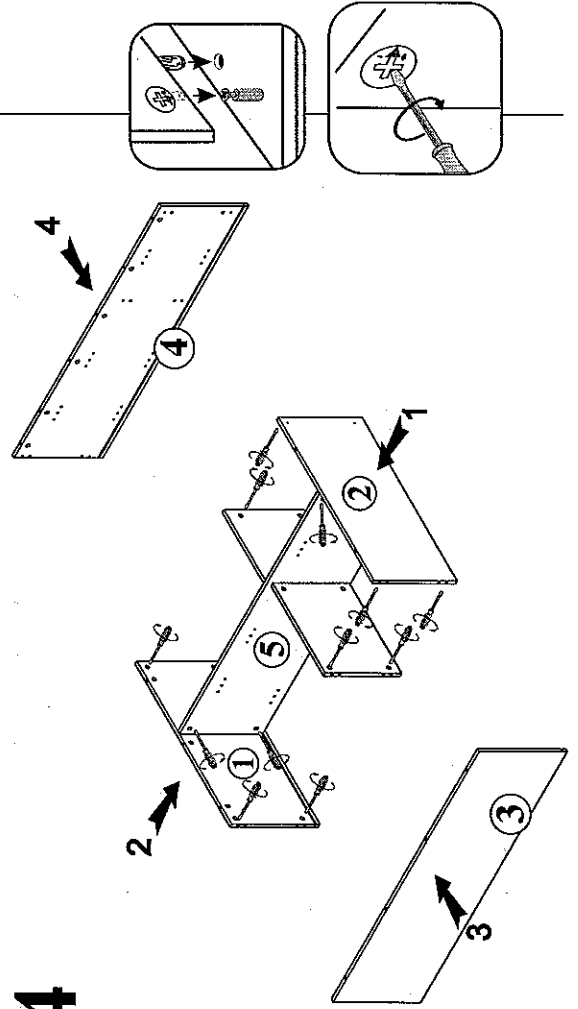

Modellname: **NATURE TWO**
 Nazwa modelu:

Modellreihe: **1211--01**
 Numer modelu:

Type: **01**
 Typ:

Blatt Nr **7** von: **9**
 Strona z:

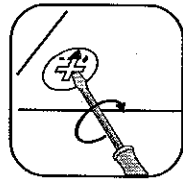
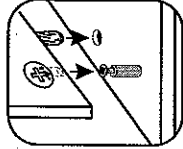
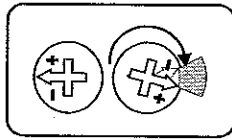
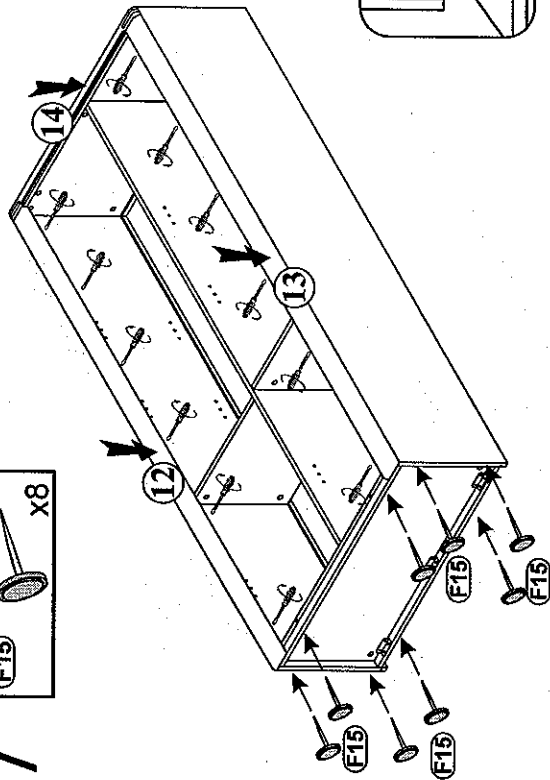

8

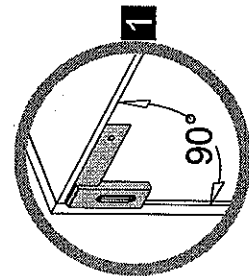
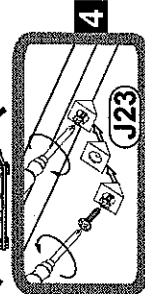
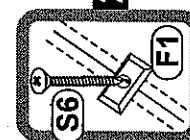
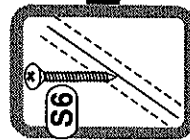
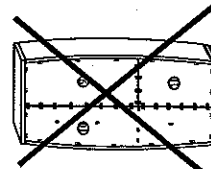
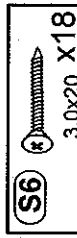
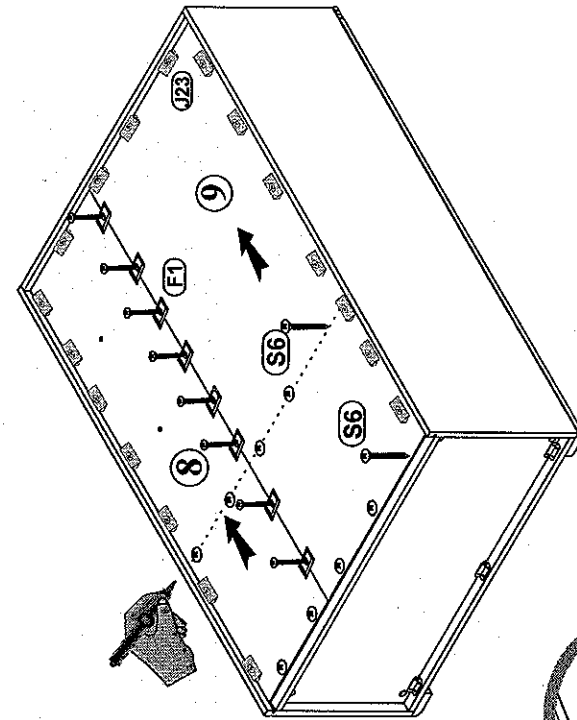

9

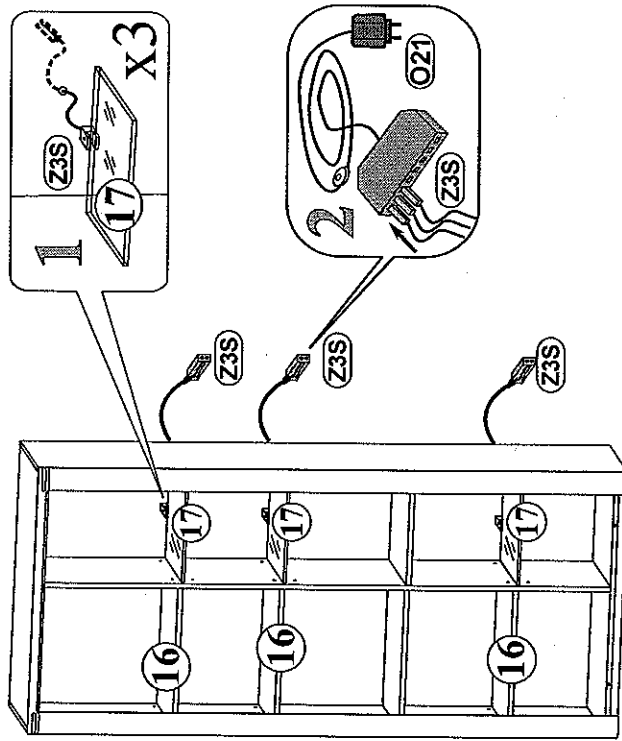
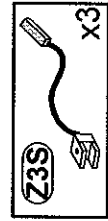
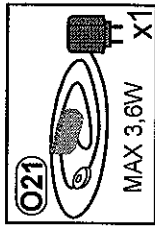

Modellname:
Nazwa modelu:

NATURE TWO

Modellreihe:
Numer modelu:

1211--01

Type: **01**
Typ:

Blatt Nr
Strona

8 von: **9**
z:

10

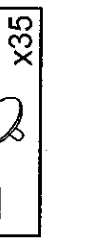
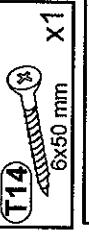
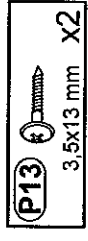
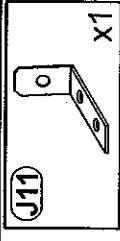
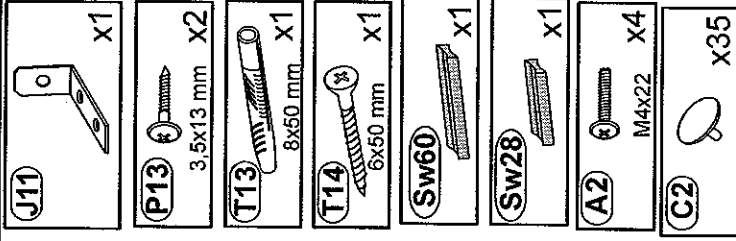
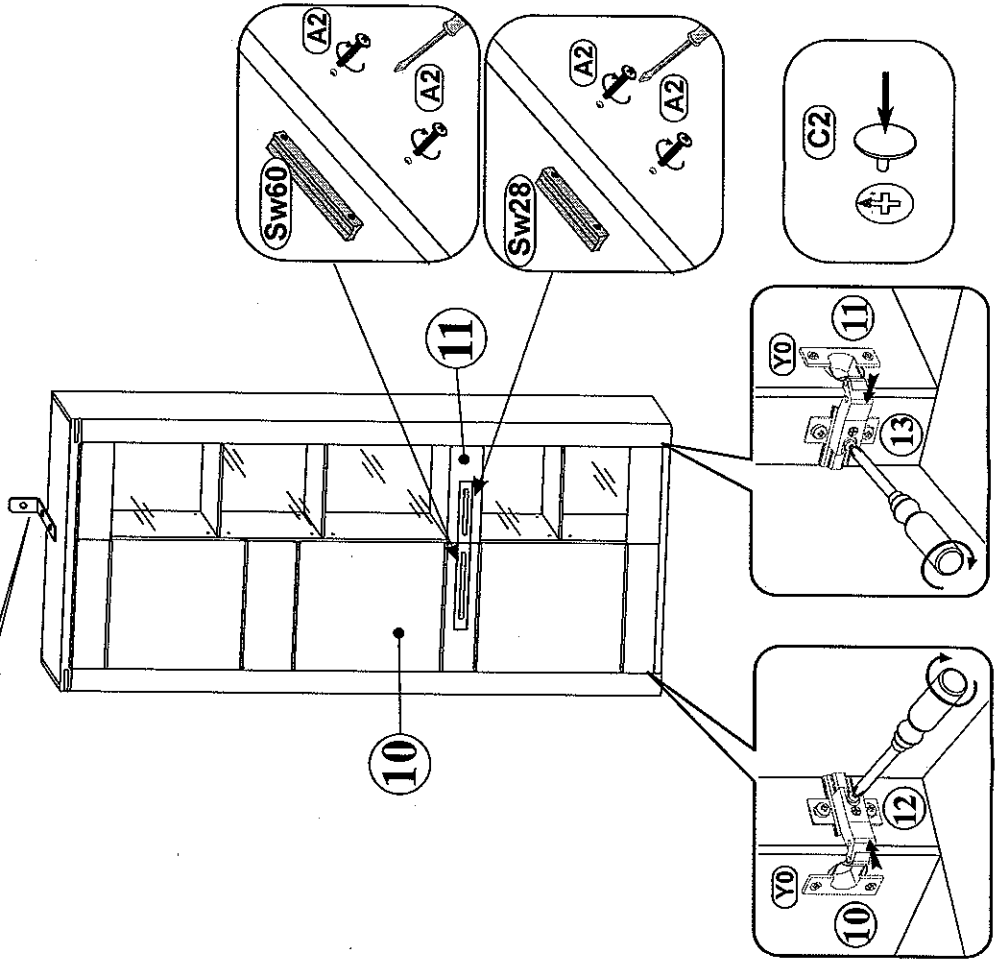
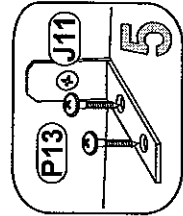
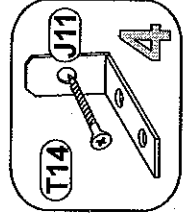
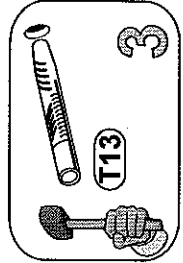
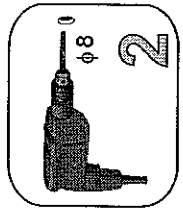
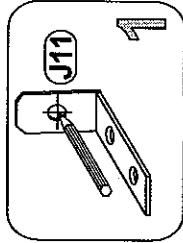
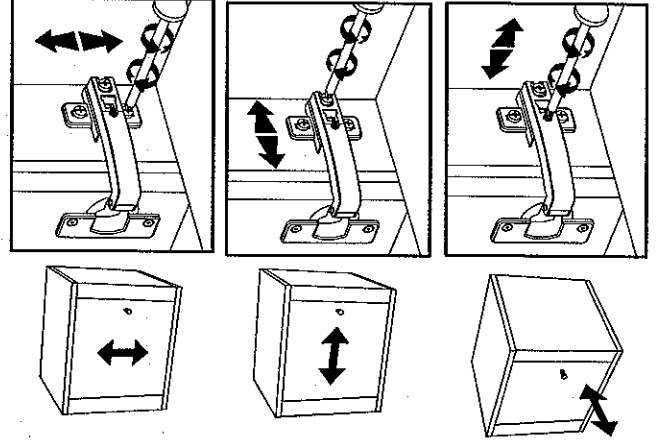
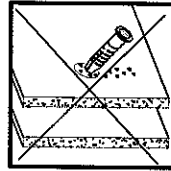
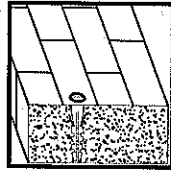
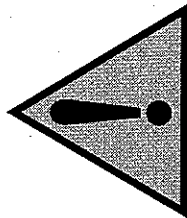
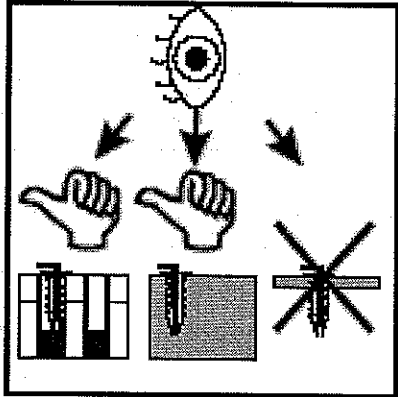

Modellname:
Nazwa modelu:

NATURE TWO

Modellreihe:
Numer modelu:

1211--01

Type:
Typ:

01

Blatt Nr
Strona

von:
z:

9

9

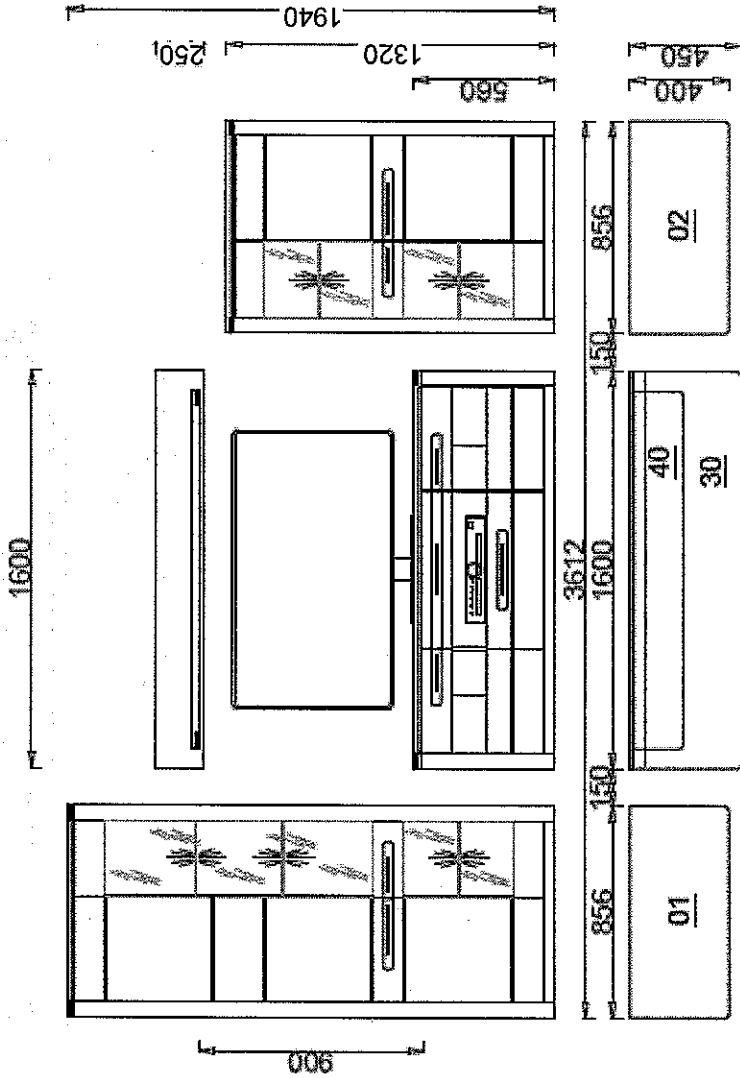

D CH AT LI LU GB US FR BE NC NL IT SI XS HR BA HU BG CZ SK SE RO ES	Kleinteile und Verpackungsfolien bei der Möbelmontage von Kindern fernhalten! Keep small parts and plastic film out of the reach of children! Tenir les petites pièces et les films plastiques hors de la portée des enfants! Houd de kleine onderdelen en de plastic folie uit de buurt van kinderen! Tenere i componenti di piccole dimensioni e le pellicole di plastica fuori dalla portata dei bambini! Majhnih delov in embalažne folije pri montaži pohištvu hranite izven dosega otrok! Műtőszereleés közben a kis alkatrészek és a csomagoló fóliák gyermekekétől távol tartandók! Дребни детайли и опаковъчни фолиа да се държат далеч от деца при монтажа на мебелите! Při montáži nábytku uchovávejte drobné díly a obalové fólie z dosahu dětí! Vid möbelmontering ska smådelar och förpackningsfolien hållas oåtkomliga för barn! Țineți departe de copii piesele mici și folia de ambalat la montarea mobilei! ¡Durante el montaje, mantenga alejados de los niños las piezas pequeñas y el material plástico de embalaje!
D CH AT LI LU GB US FR BE NC NL IT SI XS HR BA HU BG CZ SK SE RO ES	Möbelmontage muss auf ebenem Untergrund erfolgen. Bei Wandmontagen immer geeignetes Befestigungsmaterial verwenden. Furniture must be assembled on a flat surface. For assembly to the wall only use suitable fixing materials. Le meuble doit être monté sur une surface plane. Pour le montage mural, utilisez des accessoires de fixation adaptés au type de mur. De meubels dienen op een vlakke ondergrond te worden gemonteerd. Voor wandmontage moeten geschikte bevestigingsmaterialen worden gebruikt. Il montage dei mobili deve avvenire su un fondo piano. Per il montaggio si prega di utilizzare solo materiali adatti. Pohištvo je treba montirati na ravni podlagi. Pri stenski montaži vedno uporabite pritrditveni material. Namještaj se mora montirati na ravnoj podlozi. Kod montaže na zid uvijek koristite prikladan materijal za pričvršćivanje. A bútorszerelését sík felületen kell végezni. Falra szereléshez mindig megfelelő rögzítanyagot kell használni. Монтажът на мебелите да се извършва на равна основа. При стенов монтаж винаги да се използва подходящ крепежен материал. Montáž nábytku provádějte na rovném podkladu. Při montáži na stěnu používejte vždy vhodný připevňovací materiál. Montering av möbeln måste göras på jämnt underlag. Vid väggmontering ska lämpligt uppfästningsmaterial användas. Montarea mobilei trebuie să se realizeze pe o pardoseală dreaptă. La montarea la perete utilizați întotdeauna material de fixare adecvat. El montaje debe efectuarse sobre una superficie uniforme. En el montaje mural emplee siempre el material de fijación adecuado.
D CH AT LI LU GB US FR BE NC NL IT SI XS HR BA HU BG CZ SK SE RO ES	Bitte beachten Sie die Montageanleitung. Halten Sie immer die angegebene Wattzahl ein. Verhindern Sie einen Hitzestau. Please observe the assembly instructions. Do not exceed the max. given wattage. Ensure that the heat is not allowed to build up. Veuillez respecter la notice de montage. Respectez impérativement le nombre des watts maximal. Veillez à éviter toute accumulation de chaleur. Lees a.u.b. de montagehandleiding door. Houd u beslist aan het max. opgegeven wattage. Zorg ervoor dat geen hittestuwing onstaat. Attenersi alle istruzioni di montaggio. Rispettarsi rigorosamente il numero di watt max. indicato. Assicurarsi che non si verifichi un accumolo di calore. Upoštevajte navodila za montažo. Vedno upoštevajte navedeno število vatov. Preprečite zastoj vročine. Obratite molimo Vas pozor na uputu za montažu. Uvijek se pridržavajte navedenog broja vati. Izbjegavajte zastoj vrućine. Vegye figyelembe a szerelési útmutatót. Mindig tartsa be a megadott wattszámot. Akadályozza meg a hirtelődést. Моля, вземете под внимание ръководството за монтаж. Спазвайте винаги посочените ватове. Избягвайте акумулиране на топлина. Dodržujte prosím návod k montáži. Vždy dodržujte uvedenou hodnotu výkonu (watt). Zabráníte tak přehřívání. Följ monteringsanvisningen. Följ alltid angivet wattal. Undvik att hetta uppstår. Respectați instrucțiunile de montaj. Respectați întotdeauna numărul de wați impus. Evitați acumularea de căldură. Le rogamos que tenga presente las instrucciones de montaje. Respete siempre el número indicado de vatios. Evite la acumulación de calor.
D CH AT LI LU GB US FR BE NC NL IT SI XS HR BA HU BG CZ SK SE RO ES	Halten Sie die max. zulässigen Belastungswerte der Möbelteile ein. Details siehe Montageanleitung Comply with the max. permissible loads. For details, please refer to the assembly instructions Respectez les valeurs de charge max. admissibles des parties de meubles. Pour plus de détails, cf. la notice de Houd de maximaal geoorloofde belastingswaarden van de meubeldelen aan. Voor details verwijzen wij naar de montagehandleiding Rispettare la portata max. permessa degli elementi del mobile. Per dettagli si vedano le istruzioni di montaggio e si vada Upoštevajte največje dovoljeno obremenitev delov pohištvu. Podrobnosti najdete v navodilih za montažo in na Pridržavajte se maks. dozvoljenih vrijednosti opterećenja elemenata namještaja. Detalje vidi u uputi za montažu Tartsa be a bútorelemek max. megengedett terhelési értékeit. A részleteket lásd a szerelési útmutatóban Спазвайте макс. допустимите стойности на натоварване на мебелите. За подробности виж ръководството за монтаж Dodržujte max. přípustné hodnoty zatížení nábytkových dílů. Podrobnosti viz návod k montáži Följ max. tillåten belastning av möbeldelarna. Mer information finns i monteringsanvisningen Respectați valorile de solicitare max. admise pentru componentele de mobilier. Pentru detalii consultați instrucțiunile de montaj Respete los valores máximos de carga admisibles para las piezas de los muebles. Consulte los detalles en las instrucciones
D CH AT LI LU GB US FR BE NC NL IT SI XS HR BA HU BG CZ SK SE RO ES	Zur Möbelreinigung ein mit Wasser befeuchtetes, fusselreies Baumwolltuch verwenden. Gereinigte Flächen immer trockenreiben! To clean the furniture only use a water dampened lint-free cotton cloth. Once cleaned, always wipe the surfaces dry. Utilisez un chiffon en coton non pelucheux humidifié avec de l'eau pour nettoyer les meubles. Séchez systématiquement les surfaces nettoyées en les frottant! Gebruik een met water bevochtigde, pluivrije katoenen doek om de meubels te reinigen. Wrijf gereinigde oppervlakken altijd droog! Per pulire il mobile utilizzare un panno di cotone inumidito d'acqua e che non perde pelucchi. Asciugare sempre le superfici che si sono pulite! Za čiščenje pohištvu uporabljajte vlažno bombažno krpo, ki ne pušča vlaken. Očiščene površine vedno obrišite do suhega! Za čiščenje namještaja koristite sa vodom navlaženu pamučnu krpu koja ne ispušta vlakna. Očiščene površine uvijek obrišite suhom krpom! Bűrtisztításhoz vizzel benedvesített, nem szálazódó pamutkendőt használjon. A megtisztított felületeket mindig törölje szárazra! За почистване на мебелите използвайте навлажнена с вода, неизпускаща влакна памучна кърпа. Почистените повърхности винаги да се изтриват до сухо! K čištění nábytku používejte bavlněný hadr neuvolňující vlákna, navlžený ve vodě. Vyčištěné plochy vždy utřete do sucha! För möbelförrengöring används en luddfri bomullsduk fuktad med vatten. Rengjorda ytor ska alltid torkas torra! Pentru curățarea mobilei utilizați o lavetă din bumbac fără scame umezită cu apă. Suprafețele curățați se șterg întotdeauna până se usucă! Emplee un paño de algodón humedecido con agua y libre de pelusa para la limpieza de los muebles. ¡Seque siempre las superficies que ha limpiado!

<http://www.innostyle-mvg.de>

innostyle
living and dining

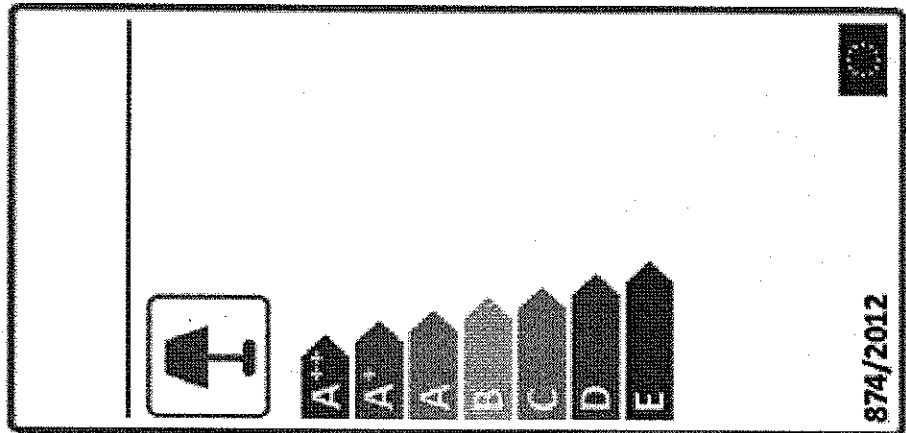

BG	Bulgarisch	български
CS	Tschechisch	čeština
DA	Dänisch	Dansk
DE	Deutsch	Deutsch
ET	Estnisch	Eesti
EL	Griechisch	ελληνικά
EN	Englisch	English
ES	Spanisch	español
FR	Französisch	Français
FI	Finnisch	suomalainen
HR	Kroatisch	hrvatski
HU	Ungarisch	magyar
IT	Italienisch	italiano
LV	Lettisch	Latvijas
LT	Litauisch	Lietuvos
NL	Niederländisch	Nederlands
PL	Polnisch	Polski
PT	Portugiesisch	português
RO	Rumänisch	român
SK	Slowakisch	slovenský
SL	Slowenisch	slovenščina
SV	Schwedisch	Svenska

